

30 Mead Lane
Herford, SG13 7GA
£1,150





30 Mead Lane Hertford, SG13 7GA

A beautiful one bedroom top floor apartment forming part of this sought-after development. With fantastic views of Hartham common and the River Lea, a five minute walk to the town centre and only two minutes walk from Hertford East station with direct links into London.

This top floor property offers bright and spacious accommodation comprising open plan living dining kitchen, bedroom with fitted wardrobes and luxury bathroom. Benefits include gas central heating large storage cupboard in the hallway the space for washer dryer and high specification of fixtures and fittings, including newly laid wooden floor.

Set in stunning well tended gardens the apartment has a gated underground parking with the benefit of having one of the only larger parking spaces.

Available to move in straight away.





Third Floor

Approx. 50.5 sq. metres (543.1 sq. feet)

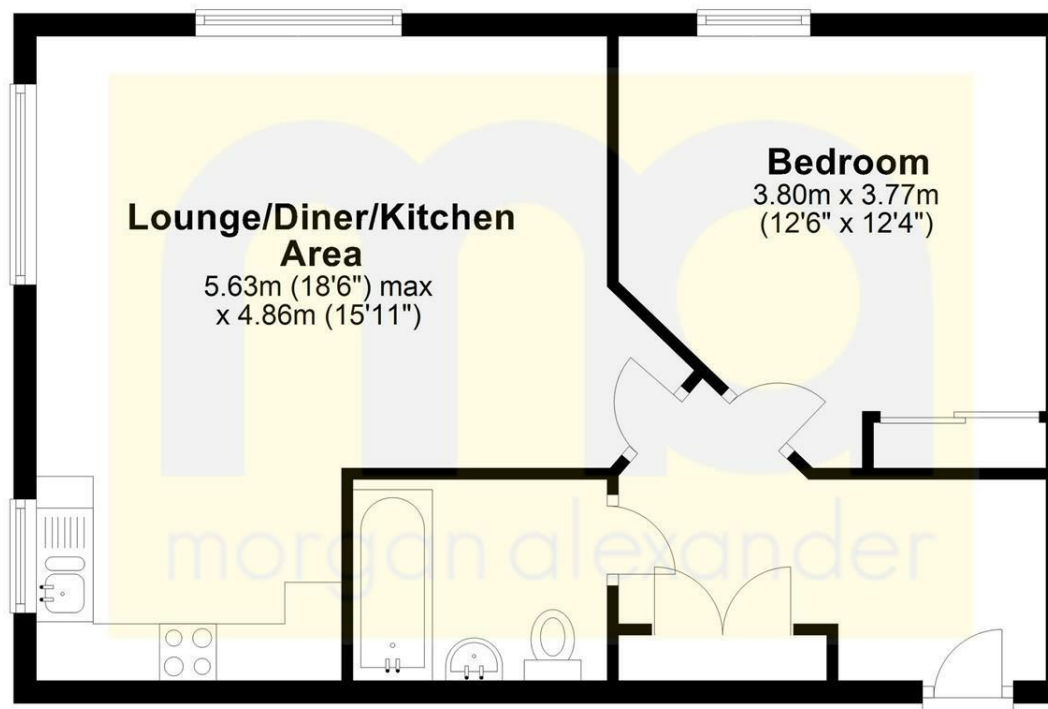

Total area: approx. 50.5 sq. metres (543.1 sq. feet)

FOR ILLUSTRATIVE PURPOSES ONLY. NOT TO SCALE
Whilst every attempt has been made to ensure the accuracy of the floor plan shown, all measurements, positioning, fixtures, features, fittings and any other data shown are an approximate interpretation for illustrative purposes only and are not to scale. No responsibility is taken for any error, omission, miss-statement or use of data shown.

| Energy Efficiency Rating | | | Environmental Impact (CO ₂) Rating | | |
|---|-------------------------|-----------|---|-------------------------|-----------|
| | Current | Potential | | Current | Potential |
| Very energy efficient - lower running costs | | | Very environmentally friendly - lower CO ₂ emissions | | |
| (92 plus) A | | | (92 plus) A | | |
| (81-91) B | | | (81-91) B | | |
| (69-80) C | | | (69-80) C | | |
| (55-68) D | | | (55-68) D | | |
| (39-54) E | | | (39-54) E | | |
| (21-38) F | | | (21-38) F | | |
| (1-20) G | | | (1-20) G | | |
| Not energy efficient - higher running costs | | | Not environmentally friendly - higher CO ₂ emissions | | |
| England & Wales | EU Directive 2002/91/EC | | England & Wales | EU Directive 2002/91/EC | |

PROPERTY MISDESCRIPTIONS ACT 1991

The agent has not tested any apparatus, equipment, fixtures and fittings, or services, so cannot verify that they are in working order or fit for their purpose or within ownership of the seller, therefore the buyer must assume the information given is incorrect. References to the Tenure of the property are based on information supplied by the Vendor. The agents have not had sight of the title documents. The buyer is advised to obtain verification from their Solicitor. The measurements supplied are for general guidance and as such must not be relied on as fact. Nothing concerning the type of construction or the condition of the structure is to be implied from the photograph of the property. The sales particulars may change in the course of time, and any interested party is advised to make a final inspection of the property prior to exchange of contracts.

morgan-alexander.co.uk



40 Castle Street, Hertford, Herts, SG14 1HH
Tel: 01992 248028
westley@morgan-alexander.co.uk